

Product Description

LED Step Lights are designed for wall or step integration and offers various design possibilities in an architectural illumination. These elegant step lights have a sleek and clean look for indoor and outdoor environment. It includes aluminum housing and mounting sleeve for easy installation.

Product Specification

Luminaire Wattage	3W
Luminaire Color	<input type="checkbox"/> White <input checked="" type="checkbox"/> Black
Light Source	CREE XP-E
Color Temperature	2700K/3000K/4000K/5000K
Color Rendering Index	Ra≥80
Luminous Flux	130lm at 3000K
Cut-out	116X56mm
Driver	ELP03SS1
Power Factor (PF)	≥0.45
Input	AC100-240V 50-60Hz
Output	DC 700mA 3V
Class	III
IP Degree	IP65
Inner Box	13X13X8cm
Carton Size	41X28X26cm
QTY/CTN	24PCS/CTN
Net Weight	0.18KG/PCS

Related references

Accessories

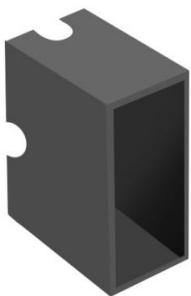

ART14-L

Model No.

RTL1401-2

CONTACT US FOR MORE DETAILS

[Weblink](#)

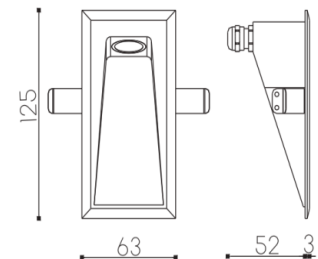

Related references

LED POWER SUPPLIES



Constant current power supply

Related project picture of product family:

